



Monarc Lighting Poles



Raheja Construction, Dindoshi Site, Malad

ID	Arms	A	H
KP-8109	Single Arm	1200	6000
KP-8105	Double Arm	2400	6000
KP-8090	Single Arm	1200	7000
KP-8093	Double Arm	2400	7000
KP-8091	Single Arm	1200	8000
KP-8094	Double Arm	2400	8000
KP-8092	Single Arm	1200	9000
KP-8095	Double Arm	2400	9000

Swaged Pole

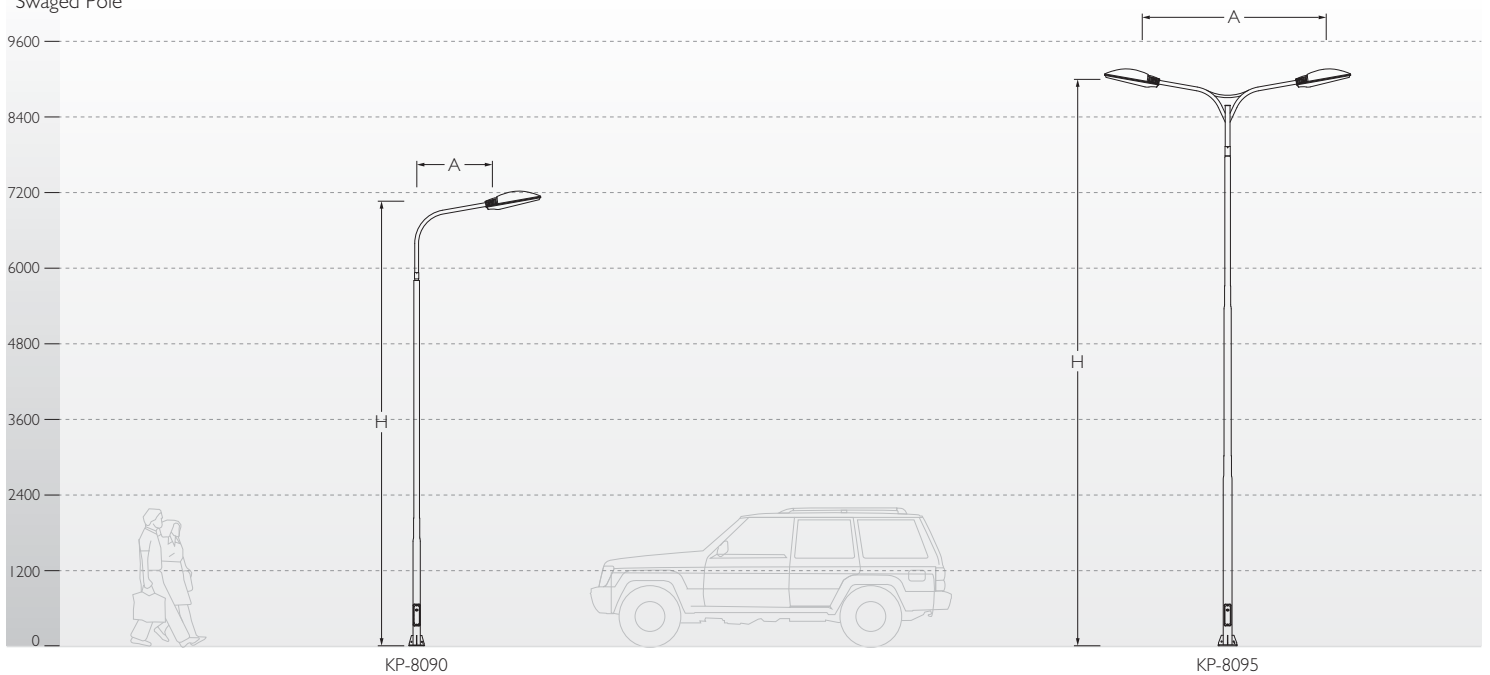

Monarc design that is both timeless and unique in its impression. Superb strength characteristics make these products ultra reliable.

Features:

- Monarc pole with single / double arm is designed for street lighting, suitable for various Street light luminaires.
- This architecturally designed pole is structurally sound, engineered to withstand adverse conditions. Pole design parameters vary depending on the type of bracket and loading factor.
- Pole sections are swaged and joint together using special v groove technique by certified welders using high end MIG welding processes.
- Built-in control box with cast aluminium service door and safety rope.
- The control gear tray is prewired with MCB, terminal connectors for loop-in loop-out arrangement.

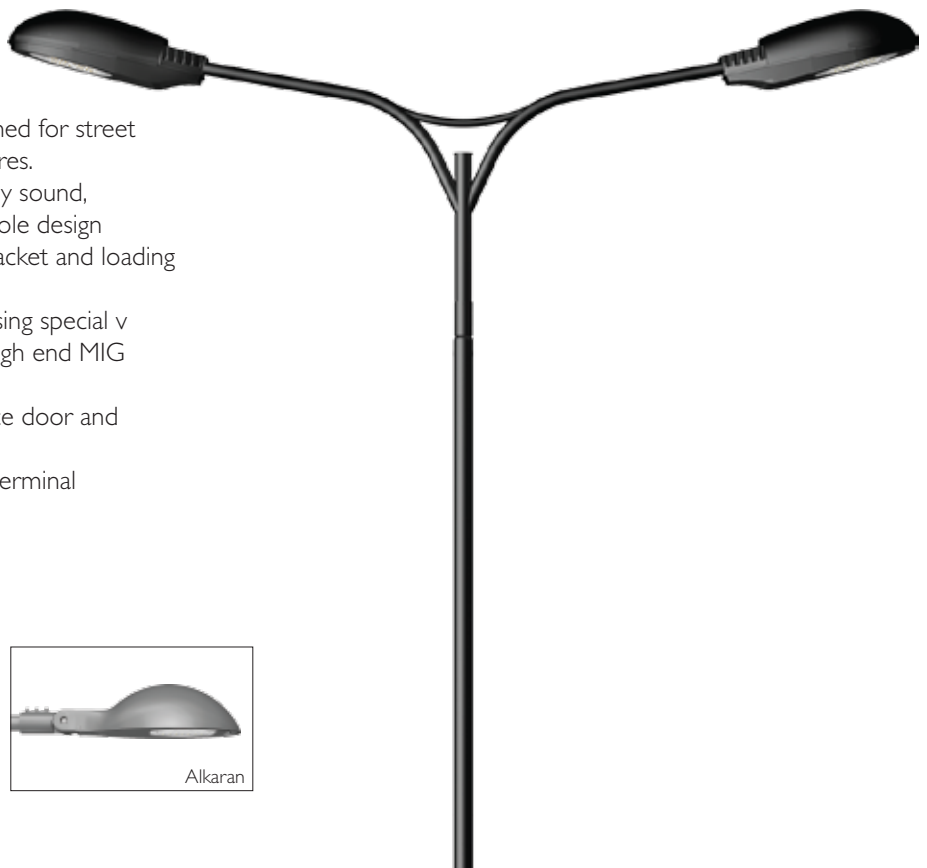

Fixture Options



Finish : Coated with epoxy zinc phosphate primer and finished using environmentally stable polyurethane based paint.

Applications : Various luminaire options make it suitable to light of roads, street, boulevards and public places, suitable for main / secondary roads and streets.

Installation : Surface mounted with base plate and fitted on a pre formed foundation.

Mounting Details

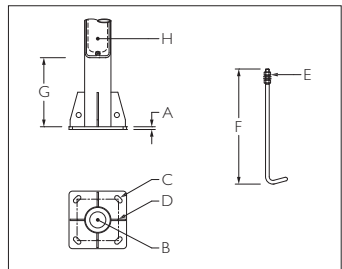

Pole Height	Base plate (A)	Cable Entry Hole (B)	No.of holes/ bolts (C)	CC (D)	Bolt (E)	Length (F)	Junction box from base plate (G)	Electrical junction box (H)
5000	□250 x 12thk	Ø70	4	180	M16	500	300	295 x 85
6000	□250 x 12thk	Ø70	4	180	M16	500	300	295 x 85
7000	□300 x 16thk	Ø70	4	215	M20	500	300	295 x 85
8000	□300 x 16thk	Ø70	4	215	M20	500	300	295 x 85
9000	□300 x 16thk	Ø70	4	215	M20	500	300	295 x 85
10000	□400 x 16thk	Ø125	4	300	M20	700	300	295 x 85
11000	□400 x 16thk	Ø125	4	300	M20	700	300	295 x 85
12000	□400 x 16thk	Ø125	4	300	M24	1000	300	295 x 85