



Polar Lean Bollard

A decorative LED bollards designed to provide soft, uniform light. A sleek minimalist shape provides distinctive lighting effects by night and decorative urban effect during the day. The luminaires contribute to safety by illuminating entrances, footpaths as well as garden and landscape architecture. Clean Lines and pure form are the underlying elements of this series of LED bollards.

Technical Specifications

- Luminaire made of MS tube with die-cast aluminium components and non corrosive SS fasteners.
- Non yellowing UV stabilized translucent acrylic diffuser.
- GI mounting plate for bolting onto a foundation.
- Cable entries for through-wiring of mains supply cable.
- Integral power supply
- Earth connection
- Safety class I
- Protection class IP54
- Prewired with LED driver and Suitable for operation on 240V, 50Hz single phase ac supply.

Product Benefits

- High luminous efficiency at reduced wattage.
- Elegant, Robust design
- Quick installation and low assembly costs.
- Dark sky compliant protects pedestrians from glare by preventing spill light above the horizontal plane.
- Sustainable LED technology offers durability and optimal light output with low power consumption.

Area of Application

Suitable for Residential & Public areas for Illuminating Driveways, Pathways, Flowerbeds, Entrances, Squares, Gardens and as well as landscape architecture.

Available Finish

Pure polyester powder coated Graphite grey / Black.

Accessory

Hot dip galvanised mounting plate with four GI steel M8 fixing foundation bolts.

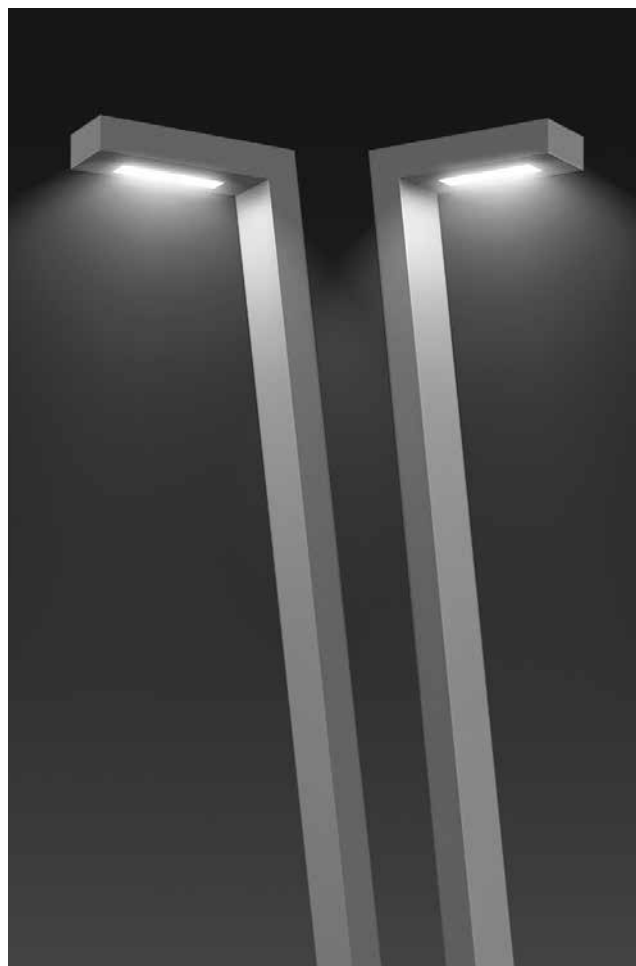

The luminous flux and the connected wattage quoted might change as a result of technical progress. For the latest technical information, Installation guidelines and product updates with LED service life please refer to the website at www.klite.in



Important Note : To ensure proper installation, kindly translate / communicate the installation instructions to a qualified electrician in their respective local language.



Polar Lean Bollard

| ID | Wattage | A | B | C | Mounting |
|------|---------|-----|-----|------|----------|
| 4234 | 6W LED | 200 | 140 | 1000 | Fig.1 |
| 4235 | 12W LED | 310 | 140 | 1000 | Fig.1 |
| 4236 | 6W LED | 353 | 140 | 1000 | Fig.1 |
| 4237 | 12W LED | 463 | 140 | 1000 | Fig.1 |



Mounting Details

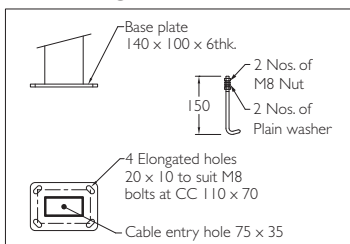

Fig.1

