

Shine Midi / Shine



"Shine" surface mounted range of LED ceiling light for interior lighting. The spun aluminium housing is ideal for better thermal management. Elegantly designed fixture under the green lighting, energy efficient category.

Technical Specifications

- Ring shaped body made of spun aluminium for better thermal management.
- Inner side of aluminium body covered with UV stabilized translucent acrylic diffuser for excellent diffused lighting experience throughout the life of the fixture.
- Cable entries for through-wiring of mains supply cable
- Protection class IP20
- CE - Conformity mark
- Suitable for operation on 240V, 50Hz single phase ac supply.
- Ordering guide : KL-3038-CCT (Colour Temperature)
- Available CCT WW : Warm White (3000K), CW : Cool White (6000K).

Product Benefits

- Attractive high quality housing and optics.
- Visual comfort with maximum energy saving
- Sturdy construction in order to maintain performance of the luminaire and to reduce maintenance costs.
- Replacement of existing CFL downlights with even better performance.
- Quick & simple installation.
- Flexible deployment options with a wide spectrum of applications.

Area of Application

Corporate Offices, Malls, Restaurants, Receptions, Corridors, Commercial & Business Centers.

Available Finish

Silver / Rose gold epoxy polyester powder coating.

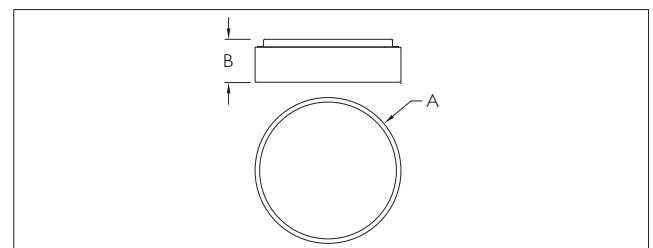

ID	Wattage	A	B
3038	27W LED	Ø450	132
3039	36W LED	Ø595	132

For Accessory, Light Distribution & Installation Recommendation please refer to our website at www.klite.in

 Important Note : To ensure proper installation, kindly translate / communicate the installation instructions to a qualified electrician in their respective local language.