

DWG. No. : KP-DFD-091  
SHEET No. : 1 of 1

ALL DIMENSIONS ARE IN mm

F

F

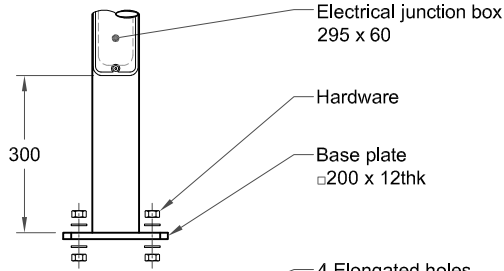

FOUNDATION TYPE	HEIGHT	DIMENSION "X"
A	8'	500
B	3m - 14'	600

E

E

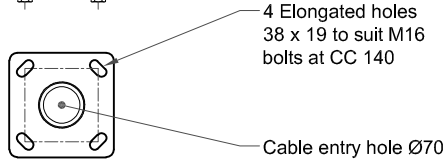

D

D

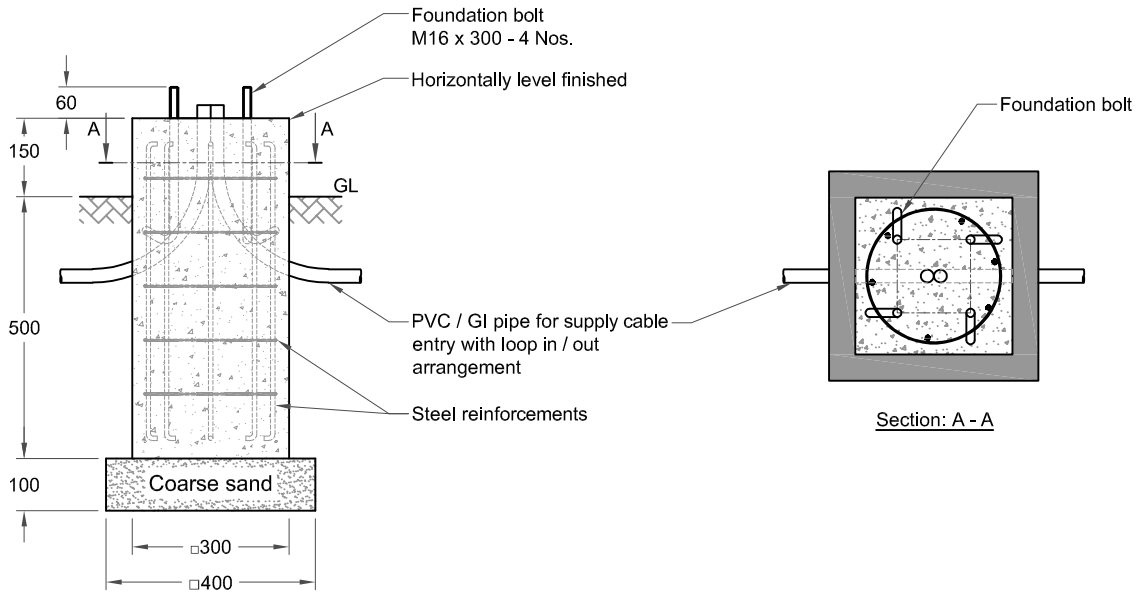

Section: A - A

**Note :**

- Typical foundation drawing suitable for standard soil condition.
- Parameters considered in RCC foundation design :
  - Load bearing capacity of soil (LBC) : 10 Mt/m<sup>2</sup> (Minimum)
  - Basic wind speed : 50 m/s
  - Grade of steel reinforcement : Fe 415
  - Grade of foundation bolt : 4.6
- Height of foundation above ground level (150mm) may be revised to suit the site conditions especially considering the expected water level stagnation.
- Template supplied is suggested to be used for locating the CC of foundation bolts.
- 4 Nos. of foundation bolt have to be oriented (located), while casting the foundation such that the door of the electrical junction box faces the required direction.
- PVC / GI pipe for entry of supply cable and the materials required for foundation are not scope of our supply.

C

C

B

B

REV. No.	REVISION DETAILS	DATE	REVISED	CHD	APPD

DRAWN BASKAR	CHECKED	APPROVED	DATE 29-05-18	SCALE 1 : 15	MATERIAL -
-----------------	---------	----------	------------------	-----------------	---------------

Z:\KP\005.FOUNDATION DETAILS\KP - DFD - 091\02.OUTLINE DWG\REV 00.DWG

DETAILED FOUNDATION DRAWING FOR KP - 44  
□200 x 12 (FOUNDATION BOLT M16 x 300)

DRG. NO. KP-DFD-091	REV 00	SHEET 1 of 1
------------------------	-----------	-----------------

A

A