

DWG. No. : KP-DFD-009
SHEET No. : 1 of 1

ALL DIMENSIONS ARE IN mm

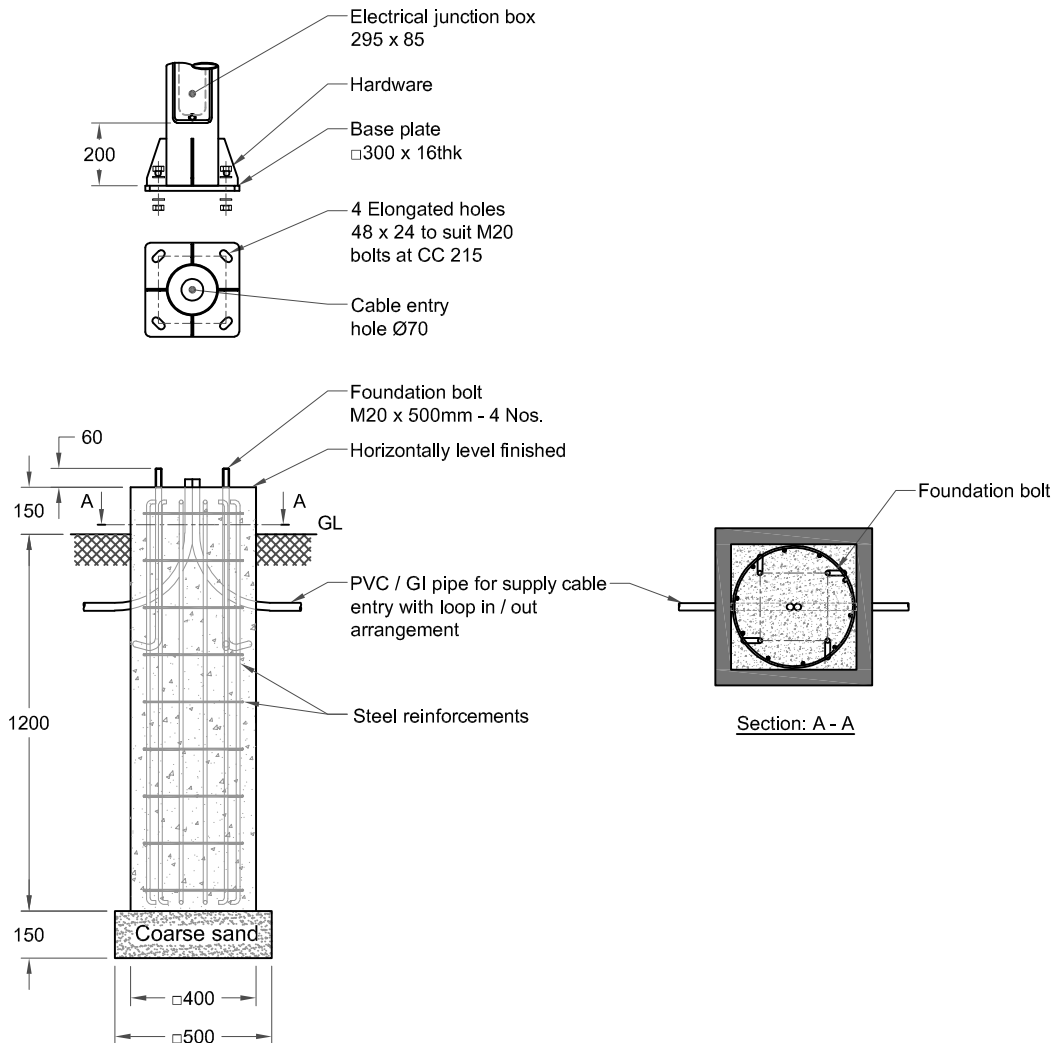

Note :

1. Typical foundation drawing for standard soil condition.
2. Parameters considered in RCC foundation design :
 - Load bearing capacity of soil (LBC) : 10 Mt/m² (Minimum)
 - Basic wind speed : 50 m/s
 - Grade of steel reinforcement : Fe 415
 - Grade of foundation bolt : 4.6
3. Height of foundation above ground level (150mm) may be revised to suit the site conditions especially considering the expected water level stagnation.
4. Template supplied is suggested to be used for locating the CC of foundation bolts.
5. 4 Nos. of foundation bolt have to be oriented (located), while casting the foundation such that the door of the electrical junction box reach the required direction.
6. PVC / GI pipe for entry of supply cable and the materials required for foundation are not scope of our supply.

03	CABLE ENTRY HOLE REVISED	13-02-19	SATHISH		
02.	BASE PLATE SIZE REVISED	19-03-18	SATHISH		
01.	DESIGN REVISED	23-01-17	SATHISH		
REV. No.	REVISION DETAILS	DATE	REVISED	CHD	APPD

DRAWN THIRUPPATHI	CHECKED	APPROVED	DATE 05-03-15	SCALE 1:25	MATERIAL -
----------------------	---------	----------	------------------	---------------	---------------

Z:\KP\005.FOUNDATION DETAILS\KP - DFD - 009\REV 03.DWG

K-LITE INDUSTRIES
CHENNAI - 600 098

DETAILED FOUNDATION DRAWING FOR KP - 30
□300 x 16 (FOUNDATION BOLT M20 x 500)

DRG. NO. KP-DFD-009	REV 03	SHEET 1 of 1
------------------------	-----------	-----------------