

KP-53

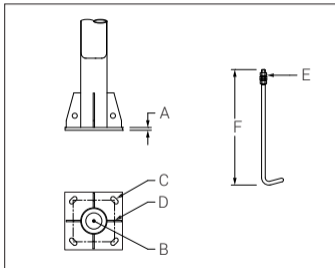

Figure	Pole Height	Base plate (A)	Cable Entry Hole (B)	No.of holes/ bolts (C)	CC (D)	Bolt (E)	Length (F)
KP-53.1	6000	□250 x 12thk	Ø70	4	180	M16	500
KP-53.2	7000	□300 x 16thk	Ø70	4	215	M20	500
KP-53.3	8000	□300 x 16thk	Ø70	4	215	M20	500
KP-53.4	9000	□300 x 16thk	Ø70	4	215	M20	500
KP-53.5	10000	□400 x 16thk	Ø125	4	300	M20	700
KP-53.6	11000	□400 x 16thk	Ø125	4	300	M20	700
KP-53.7	12000	□400 x 16thk	Ø125	4	300	M24	1000