



JDA WONDERLAND PARK, JAIPUR



Symmetrical



Asymmetrical

**Technical Specifications**

**General**

ID : 24092 (Sym) / 24093 (Asy)  
 System Wattage : 3W LED  
 Driver Integral : Constant Current  
 Operating Voltage : 150-270Vac  
 Operating Temperature : -15°C~+50°C

**Light Source**

Light Source : NICHIA  
 CRI (Ra) : ≥80  
 LED Colour Temperature : 2700K / 3000K / 4000K / 5700K

**Physical**

Body : Die-Cast Aluminium  
 Front Ring : 316 Grade Stainless Steel  
 Diffuser : Clear Toughened Glass  
 Mounting Sleeve : Polypropylene Black  
 Mounting : Recess

**Driver**

Input Voltage : 240Vac  
 Frequency : 50-60 Hz

**Optical Performance**

Beam Angle (Sym) : 12° / 24° / 40°

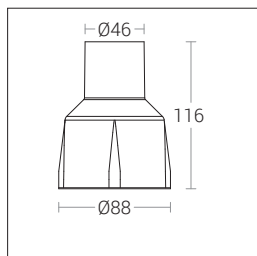
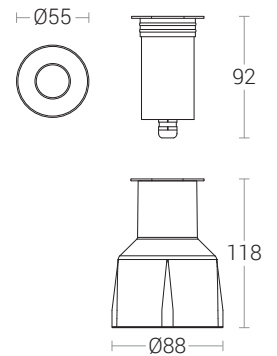

**Note :** It is our constant endeavor to upgrade the performance of our products. For the latest technical information, IES files and product updates please refer to the website at [www.klite.in](http://www.klite.in)